

SOUTHWEST FLORIDA YACHTS

INC.



Grand Banks 42 Classic Trawler Twin Engine, Double Cabin “MAR-KAT”



Comments: MAR-KAT is a beautiful example of the quality and simplicity that is purely Grand Banks. With her double cabin/ double head arrangement, this yacht is perfectly suited for cruising with two couples or a family group. You'll cruise in style through our barrier islands and with her twin Caterpillar diesels, MAR-KAT will get you there in plenty of time to watch the sunset! Join us soon for a MAR-velous cruise aboard MAR-KAT!

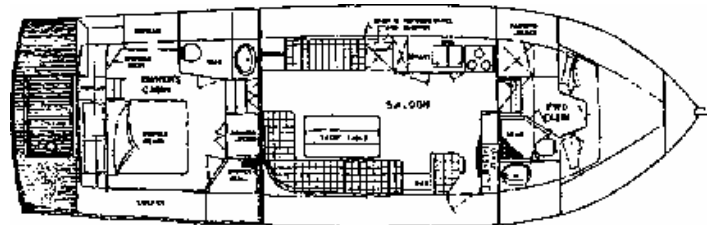

Inventory and Equipment List
Grand Banks 42 Classic
MAR-KAT

Fiberglass trawler with teak decks
 Length overall: 42' 7"
 LWL : 40' 9.5"
 Beam: 13' 7"
 Draft: 4' 2"
 Displacement: 34,000 lbs.
 Fuel capacity: 600 gallons
 Water capacity: 265 gallons
 Berths: 5
 Fwd. cabin: Double - 81"x 99"x18"
 Main salon: Single - 26"x98"
 Aft cabin: Double - 76"x54"
 Headroom 6'6"
 Teak interior
 Parquet flooring
 Entry doors: Port and Starboard sides
 Galley up, port side
 L-shaped dinette with table
 Heads: (1) manual and (1) electric, with holding tank
 Showers: (2)
 Macerator pump
 Interior lighting, 12VDC
 Power - Twin Caterpillar 375 hp, 8 cyl, FWC diesels
 Bow thruster
 Niad stabilizers
 Cruise speed: 8-10 knots @ 1850 RPM (approx.)
 Fuel consumption: 8 gal./hr. (approx.)
 Fuel filtration: Dual Racor filters w/ vac. Gauges
 Generator - Onan 8 kw. 3 cylinder diesel
 Engine room lighting
 Engine compartment ventilation, 12 VDC blowers
 Sight gauges on fuel tanks
 Air conditioning: Three zone with reverse cycle heat; all
 cabins individually controlled.
 Batteries: Four (4) heavy duty marine batteries;
 (3) 8-D and (1) 4-D type
 Battery charger: Sentry 40 amp.
 Electrical control panels: 12 VDC and 110 VAC
 125/250 VAC x 50 amp. shore power system
 Shore power cord: 50 amp, 125/250 VAC
 Mechanical steering
 Emergency tiller steering
 Hot and cold pressure water system
 Cold plate refrigeration - Grunert 12 VDC
 Three (3) burner Princess electric stove with oven
 Ice maker: U-line model 45, 110 VAC
 Microwave oven
 Stainless steel galley sink
 Exhaust fan in galley
 Bilge pumps, automatic electric and manual
 AM/FM Stereo with cassette player
 26" color flat panel LCD HD TV with DVD player
 Ship's clock and barometer
 Intercom system
 US Yacht flag
 Life jackets
 Life ring

Compasses: Danforth Constellation compasses, both helms
 Engine instrument panels, both helms
 Engine hour meters, lower helm
 Generator hour meter, aft on generator
 VHF Radios, both helms
 GPS: Chart plotter, Raymarine E80
 Radar: Raymarine E Series
 Depth sounders:
 Autohelm ST50 at both helms
 Autopilot: Raymarine ST8002
 Electric Windlass:
 Lofrans Tigress on bow platform with
 foot control switches & switches at both helms
 Anchors: 45 lb. CQR Plow with 150' of 3/8" BBB chain
 20 lb. Danforth-type with 150' rode
 Fire extinguishers
 Fireboy clean agent fire extinguishing system in engine
 room
 Docklines and fenders
 Deck bucket and brush
 Boathook
 Binoculars
 Ship's logbook
 Charts and cruising guide
 Navigation tools
 Navigation lights
 Flare kit
 First Aid Kit
 Teak handrails with opening gates
 Teak swim platform with boarding ladder
 Teak transom with steps
 US Yacht flag on teak staff with canvas cover
 Hatch and window screens
 Canvas front window covers
 Canvas flybridge cover
 Bimini top with extension on flybridge
 Bridge seating with cushions
 Folding deck chairs on bridge (2)
 Flybridge weathercloths / side canvas windscreens
 Dinghy: Avon 10' Rover RIB inflatable with fiberglass
 bottom, seat, oars and foot pump
 Canvas cover for dingy
 Dinghy lifting bridle
 Yamaha 4 hp, 4 stroke outboard motor
 Tool kit
 Engine and generator spare parts
 Air horn
 Radar reflector
 Handheld spotlight
 "Spurs" line, net and weed cutter on shafts
 Floodlights on spreaders
 Igloo cooler, 72 qt.
 Frigid Rigid 6 cu. ft. freezer on flybridge, 110VAC
 Magma charcoal grill with rail mount
 Linens and towels for (6)
 Galley gear for (6)

Equipment may vary • Specifications are approximate • Capacities are approximate

Revised 4/09

